

Blum® Rollout Installation Instructions

- 1. For Single Roll Out, cut verticle rails in half. Use for right and left sides.**

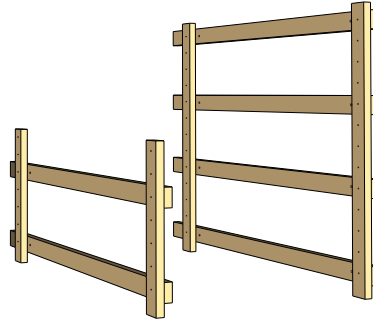

- 2. Install wooden frames to side panels.**

The 2 horizontal rails should protrude at the rear or the cabinet. Insert 1" screws into the 4 pre-drilled holes.

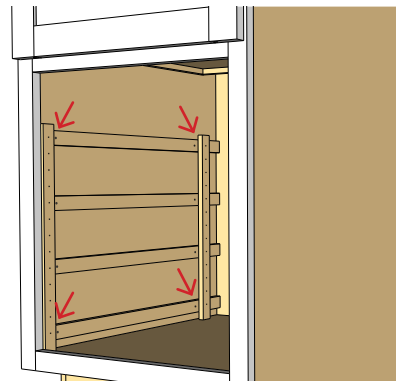

- 3. Install Blum® clips on underside of drawer box**

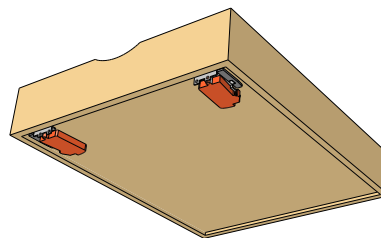

- 4. Install Blum® slides using 2 screws for each slide.**

Place slides at desired height.
 The front screw should go into the first hole on the bottom row.
 The rear screw should go into the front of the long hole on the bottom row.

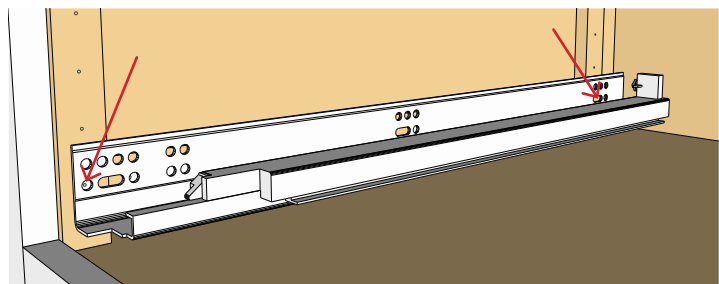

Blum® Rollout Installation Instructions

5. Pull out slides and insert drawer

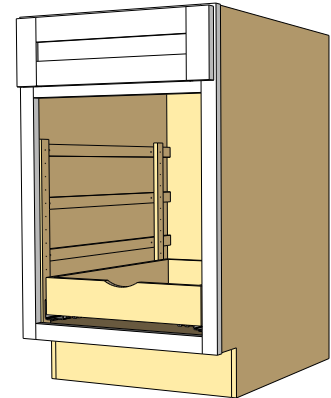
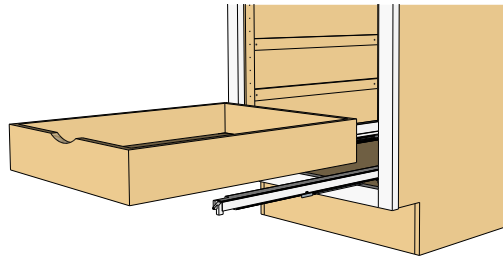
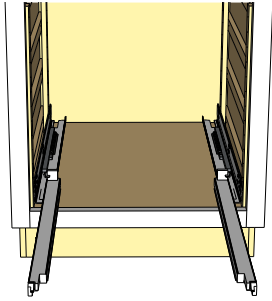

Single Roll Out
with Shelf:

