

Construction Specifications

Doors and Drawer Fronts:

Doors and drawer fronts in the Allure line are made of solid wood stiles and rails joined together using mortise and tenon joints with an MDF center panel to reduce the possibility of shrinkage and is the preferred material for painted finishes.

Hinges:

All Allure door styles come standard with Blum Compact Clip Concealed Hinges and feature Quick-Release Technology with Blumotion Soft-close. Hinges are six-way adjustable and open at 110°.

Please note: Lazy Susan, Easy Reach, and Pie Cut cabinets do not feature the soft-close mechanism.

Drawers:

The Allure line includes a 5/8" thick solid wood dovetail drawer box with a 3/8" plywood bottom attached to Tandem plus Blumotion full extension soft-closing concealed drawer runners. Interior drawer height is 3".

Shelving:

18mm (3/4") thick select veneered plywood with matching wood veneer edge banding is used on all wall, tall, and base cabinetry where applicable. The adjustable shelves are supported by metal shelf clips. All standard depth base cabinetry includes an 18" deep adjustable shelf, wall cabinetry 10 5/8" deep adjustable shelves, and tall cabinetry 21" deep adjustable shelves.

Cabinet Sides, Backs, Tops and Bottoms:

1/2" thick veneered plywood with natural finished interiors, dovetailed side panels engineered to create a solid integrated cabinet box. Backs are stapled and screwed into place for additional support.

Face Frame:

3/4" x 1 1/2" solid wood stiles and rails jointed with glue and dowels. Back of face frames are dovetail grooved to accept side panels. The face frame is engineered so that the bottoms of all base and wall cabinets are flushed with the top inside edge of the face frame creating a custom look.

Toe Kick:

Base and tall cabinets are constructed with 3/4" x 4 1/2" unfinished plywood* toe kick. Additional 8-foot lengths of 1/4" toe kicks are available in matching color to our cabinetry.

Panel Beams:

2 1/2" x 1/2" plywood* panel beam is fastened into a dovetail groove at the top of each base cabinet to ensure a straight fully integrated side, and for use of support and mounting of a countertop.

* *May come in finish other than natural ply, this does not denigrate the quality of material or structure of the cabinet.*

Construction Specifications

- 1 Solid wood door and drawer front frames are mortise and tenon.
- 2 Compact Clip Hinges with Quick-Release technology. Includes Blumotion soft-close mechanism integrated in six-way adjustable hinges. Hinges open at 110°
- 3 $\frac{5}{8}$ " solid wood dovetail drawer with a $\frac{3}{8}$ " plywood bottom features Tandem plus Blumotion full extension concealed drawer runners.
- 4 3" interior drawer height.
- 5 $\frac{3}{4}$ " x $1\frac{1}{2}$ " solid wood face frame.
- 6 $\frac{1}{2}$ " veneered plywood back with a natural finished interior.
- 7 $\frac{1}{2}$ " unfinished plywood side panels dovetailed into face frame.
- 8 18mm ($\frac{3}{4}$ ") veneered plywood adjustable shelving with matching wood veneer edge banding.
- 9 $\frac{3}{4}$ " x $4\frac{1}{2}$ " unfinished plywood toe kick attached to cabinet. Matching $\frac{1}{4}$ " Toe Kick cover to be ordered separately.
- 10 $2\frac{1}{2}$ " x $\frac{1}{2}$ " plywood* panel beams dovetailed into the side panels for strength and stability.
- 11 Base cabinet has 18" deep shelf.
- 12 When placing an order, need to select exposed sides; Right, Left or Both. A $\frac{1}{4}$ " select medium-density fiberboard panel will be applied to the selected side(s), and the side will be near flush finished.
- 13 Doors and drawers are full overlay
- 14 Wall cabinet has a full overlay door. Crown molding should be installed using STRM-8 Starter Molding or similar molding bracing.

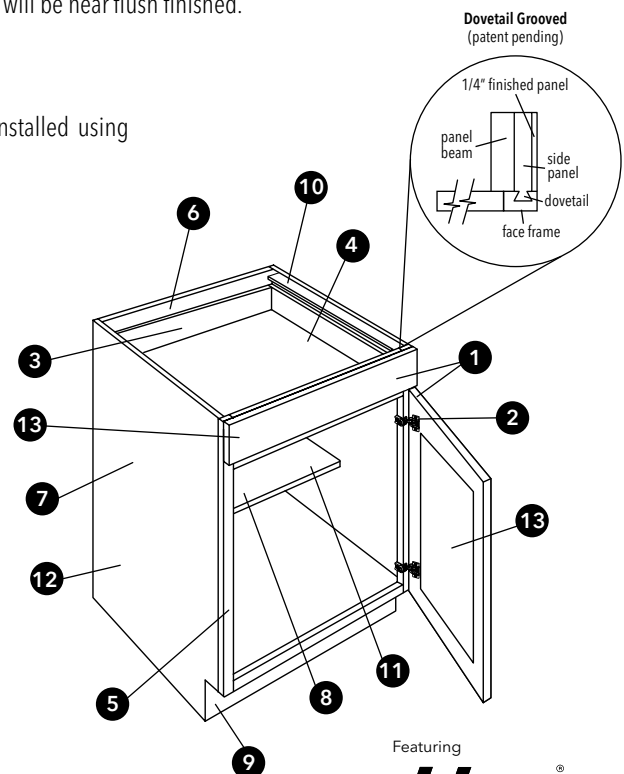
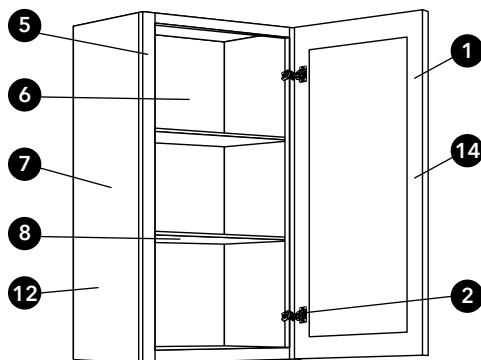

* May come in finish other than natural ply, this does not denigrate the quality of material or structure of the cabinet.

Featuring
blum[®]